



# Wide Opening and Gentle Closing for Large Doors



SELECTION GUIDE

HES CONCEALED HINGES

CONCEALED HINGES

DAMPER HINGES

TORQUE HINGES

GLASS HINGES

PIVOT HINGES

TABLETOP HINGES

DETENT HINGES

BUTT HINGES

LIFT-OFF HINGES

PIANO HINGES

SPRING HINGES

ANGLE HINGES

GRAVITY HINGES

Wide Angle Opening: No Obstructions, Even for Large Doors

Elevate Luxury with Soft Close Functionality



Because the door can be opened up to 160°, even large doors stay out of the way when open.

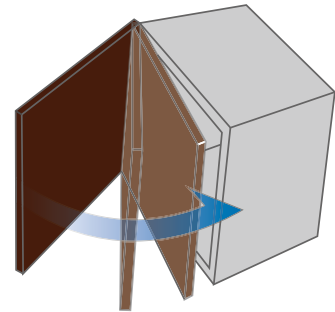

Because the hinge contains a damper, the door can be closed gradually, quietly, and safely, enabling movement with a touch of class.



Mount the top and bottom hinges within 200 mm from the door edges. When using 3 pieces, keep the mounting pitch uniform.



Higher installation efficiency as well

Easy Operation:

Number of pieces reduced (mounting time shortened)  
Conventional Sugatsune product

One-Touch Mounting and Removal

Equipped with Door Anti-Drop Feature

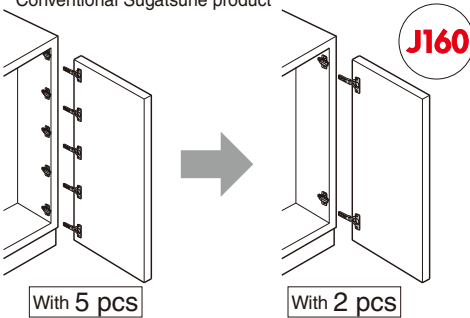

Fewer required pieces than the conventional concealed hinge reduce installation time and provide a clean appearance.

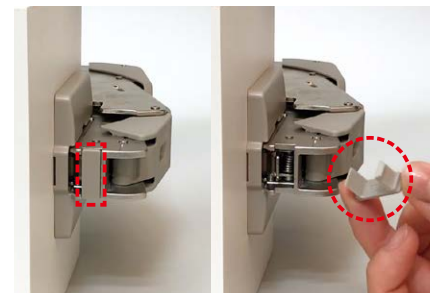
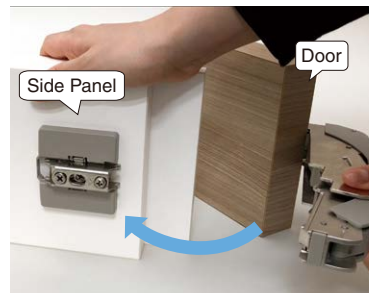

Fallout prevention cover keeps the door in place in the case of misoperation.

# LAMP WIDE-ANGLE HEAVY-DUTY CONCEALED HINGE J160 Built-in Damper NEW

Latest Info



A  
HINGES

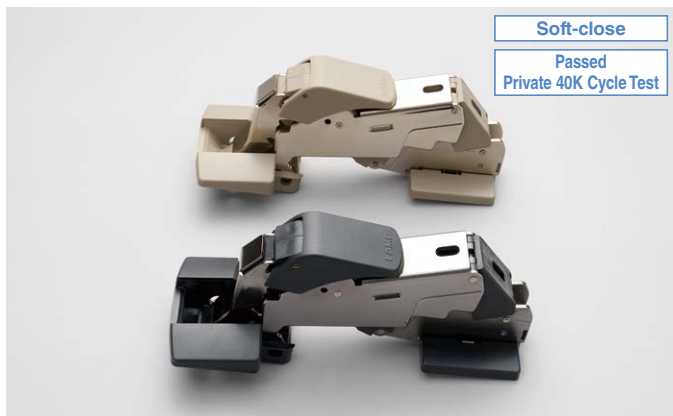

Soft-close  
Passed Private 40K Cycle Test

- The built-in damper allows doors to close slowly providing premium door motion.
- Comes with a mounting plate and screw covers.

### Specification

- 3-way adjustment of door position is available as below:
  - Depth : +1.5 mm / -2.5 mm
  - Vertical : ±3 mm
  - Overlay (horizontal) : +0 mm / -4 mm

### Remarks

- Comes with a red holding pin which holds the hinge angle. Please do not detach it until the hinge is installed
- Please do not open and close the hinge while the holding pin is attached.

### Parts Included

- Cross-recessed raised countersunk tapping screw 5×18

160° Opening    Overlay: 25 mm    Door Thickness 18 - 36 mm



SELECTION GUIDE

HES CONCEALED HINGES

CONCEALED HINGES

DAMPER HINGES

TORQUE HINGES

GLASS HINGES

PIVOT HINGES

TABLETOP HINGES

DETENT HINGES

BUTT HINGES

LIFT-OFF HINGES

PIANO HINGES

SPRING HINGES

ANGLE HINGES

GRAVITY HINGES

### Drawing

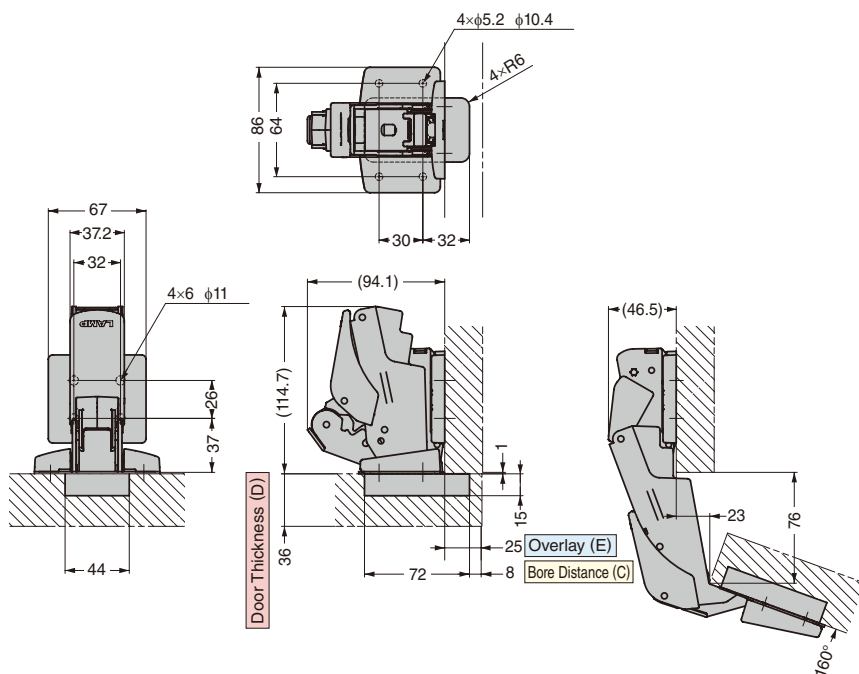

### Locus Chart

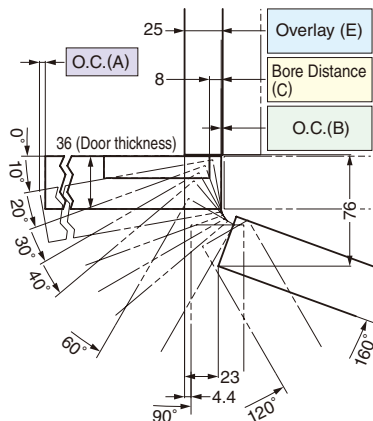

### [ Bore Distance (C) ]

Table-1

Bore Distance (C)	3	4	5	6	7	8
Overlay (E)	20	21	22	23	24	25

Overlay adjustment (Max. -4mm) by turning the overlay adjustment screw.

### [ Opening Clearance (O.C.) ]

Clearances for door edge O.C. (A) and hinge side O.C. (B) are necessary. O.C. (A) and (B) change depending on door thickness and bore distance (C). Refer to locus chart and tables below when designing cabinets.

### [ O.C. (B) ]

Table-2

Door Thickness (D)	Bore Distance (C)					
	3	4	5	6	7	8
34 and under	0.1 and under					
36	0.2	0.2	0.2	0.2	0.2	0.2
38*	0.5	0.5	0.5	0.5	0.6	0.6
40*	1.0	1.0	1.1	1.2	1.3	1.4

O.C. (B)

\*Please refer to the locus chart if door thickness is over 36 mm. (O.C. (B) can be made smaller by R chamfering (round chamfer) or C chamfering (chamfer plane) on the door)

### [ O.C. (A) ]

Table-3

Door Thickness (D)	Door Width						
	300	400	500	600	700	800	900
20	1.6	1.2	1.0	0.8	0.7	0.6	0.5
30	1.9	1.4	1.2	1.0	0.8	0.7	0.7
36	1.9	1.5	1.2	1.0	0.8	0.7	0.7

O.C. (A)

### Cut Out Dimensions

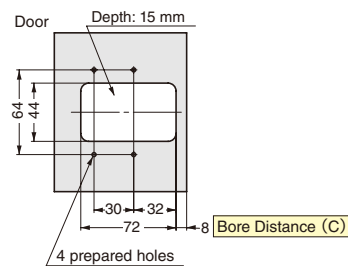

[Door Dimensions and Number of Hinges] (P.67)

Item Code	Item Name	Specification	Material	Finish	Weight (g)	Carton (pcs)
160-044-973	J160-D22-25T-NI	Built-in Damper	Steel, Zinc Alloy (ZDC), Glass Filled Polyamide (PA)	Nickel	710	50
160-044-974	J160-D22-25T-BN			Black Nickel	710	50